

ECO3

COLONNA CON TESTA

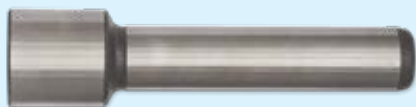

MAT : 1.7131

DUREZZA : 61 ÷ 63 HRC

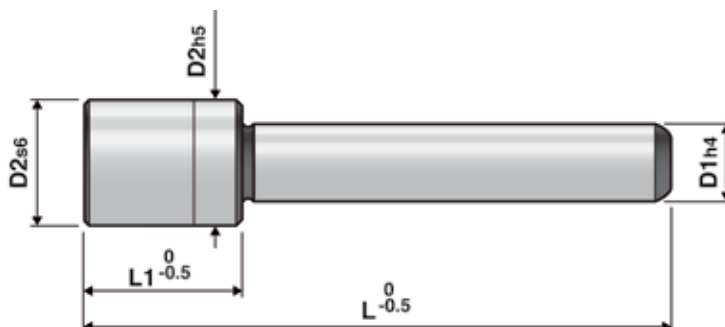

| Codice | D1 | L | D2 | L1 |
|------------|----|-----|----|----|
| ECO301585 | 15 | 85 | 26 | 30 |
| ECO301595 | 15 | 95 | 26 | 30 |
| ECO3015105 | 15 | 105 | 26 | 30 |
| ECO3015115 | 15 | 115 | 26 | 30 |
| ECO3015125 | 15 | 125 | 26 | 30 |
| ECO3015135 | 15 | 135 | 26 | 30 |
| ECO3015145 | 15 | 145 | 26 | 30 |
| ECO3015155 | 15 | 155 | 26 | 30 |
| ECO301685 | 16 | 85 | 26 | 30 |
| ECO301695 | 16 | 95 | 26 | 30 |
| ECO3016105 | 16 | 105 | 26 | 30 |
| ECO3016115 | 16 | 115 | 26 | 30 |
| ECO3016125 | 16 | 125 | 26 | 30 |
| ECO3016135 | 16 | 135 | 26 | 30 |
| ECO3016145 | 16 | 145 | 26 | 30 |
| ECO3016155 | 16 | 155 | 26 | 30 |
| ECO301785 | 17 | 85 | 28 | 30 |
| ECO301795 | 17 | 95 | 28 | 30 |
| ECO3017105 | 17 | 105 | 28 | 30 |
| ECO3017115 | 17 | 115 | 28 | 30 |
| ECO3017125 | 17 | 125 | 28 | 35 |
| ECO3017135 | 17 | 135 | 28 | 35 |
| ECO3017145 | 17 | 145 | 28 | 35 |
| ECO3017155 | 17 | 155 | 28 | 35 |
| ECO3017170 | 17 | 170 | 28 | 35 |
| ECO3017185 | 17 | 185 | 28 | 35 |
| ECO3017200 | 17 | 200 | 28 | 35 |
| ECO301885 | 18 | 85 | 28 | 30 |
| ECO301895 | 18 | 95 | 28 | 30 |
| ECO3018105 | 18 | 105 | 28 | 30 |
| ECO3018115 | 18 | 115 | 28 | 30 |
| ECO3018125 | 18 | 125 | 28 | 35 |
| ECO3018135 | 18 | 135 | 28 | 35 |
| ECO3018145 | 18 | 145 | 28 | 35 |
| ECO3018155 | 18 | 155 | 28 | 35 |
| ECO3018170 | 18 | 170 | 28 | 35 |
| ECO3018185 | 18 | 185 | 28 | 35 |
| ECO3018200 | 18 | 200 | 28 | 35 |

ECO3

COLONNA CON TESTA



MAT : 1.7131

DUREZZA : 61 ÷ 63 HRC

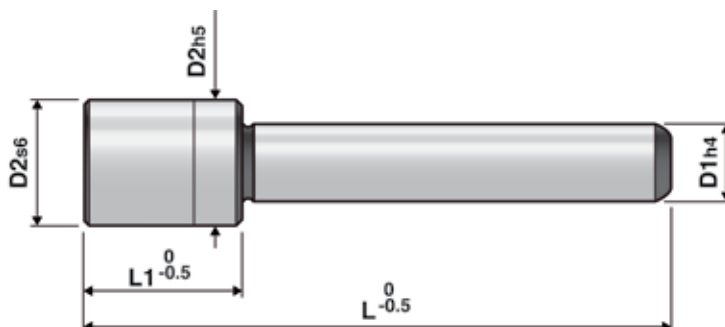

| Codice | D1 | L | D2 | L1 |
|------------|----|-----|----|----|
| ECO301985 | 19 | 85 | 30 | 30 |
| ECO301995 | 19 | 95 | 30 | 30 |
| ECO3019105 | 19 | 105 | 30 | 30 |
| ECO3019115 | 19 | 115 | 30 | 35 |
| ECO3019125 | 19 | 125 | 30 | 35 |
| ECO3019135 | 19 | 135 | 30 | 35 |
| ECO3019145 | 19 | 145 | 30 | 35 |
| ECO3019155 | 19 | 155 | 30 | 35 |
| ECO3019170 | 19 | 170 | 30 | 35 |
| ECO3019185 | 19 | 185 | 30 | 35 |
| ECO3019200 | 19 | 200 | 30 | 35 |
| ECO302085 | 20 | 85 | 30 | 30 |
| ECO302095 | 20 | 95 | 30 | 30 |
| ECO3020105 | 20 | 105 | 30 | 30 |
| ECO3020115 | 20 | 115 | 30 | 35 |
| ECO3020125 | 20 | 125 | 30 | 35 |
| ECO3020135 | 20 | 135 | 30 | 35 |
| ECO3020145 | 20 | 145 | 30 | 35 |
| ECO3020155 | 20 | 155 | 30 | 35 |
| ECO3020170 | 20 | 170 | 30 | 35 |
| ECO3020185 | 20 | 185 | 30 | 35 |
| ECO3020200 | 20 | 200 | 30 | 35 |
| ECO3024115 | 24 | 115 | 36 | 35 |
| ECO3024125 | 24 | 125 | 36 | 35 |
| ECO3024135 | 24 | 135 | 36 | 35 |
| ECO3024145 | 24 | 145 | 36 | 40 |
| ECO3024155 | 24 | 155 | 36 | 40 |
| ECO3024170 | 24 | 170 | 36 | 40 |
| ECO3024185 | 24 | 185 | 36 | 40 |
| ECO3024200 | 24 | 200 | 36 | 40 |
| ECO3024225 | 24 | 225 | 36 | 40 |
| ECO3024250 | 24 | 250 | 36 | 40 |
| ECO3025115 | 25 | 115 | 36 | 35 |
| ECO3025125 | 25 | 125 | 36 | 35 |
| ECO3025135 | 25 | 135 | 36 | 35 |
| ECO3025145 | 25 | 145 | 36 | 40 |
| ECO3025155 | 25 | 155 | 36 | 40 |
| ECO3025170 | 25 | 170 | 36 | 40 |

ECO3

COLONNA CON TESTA

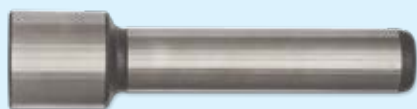

MAT : 1.7131

DUREZZA : 61 ÷ 63 HRC

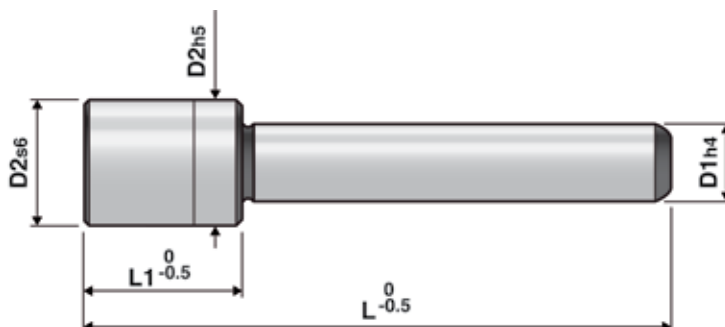

| Codice | D1 | L | D2 | L1 |
|------------|----|-----|----|----|
| ECO3025185 | 25 | 185 | 36 | 40 |
| ECO3025200 | 25 | 200 | 36 | 40 |
| ECO3025225 | 25 | 225 | 36 | 40 |
| ECO3025250 | 25 | 250 | 36 | 40 |
| ECO3030115 | 30 | 115 | 45 | 40 |
| ECO3030125 | 30 | 125 | 45 | 40 |
| ECO3030135 | 30 | 135 | 45 | 40 |
| ECO3030145 | 30 | 145 | 45 | 40 |
| ECO3030155 | 30 | 155 | 45 | 40 |
| ECO3030170 | 30 | 170 | 45 | 45 |
| ECO3030185 | 30 | 185 | 45 | 45 |
| ECO3030200 | 30 | 200 | 45 | 45 |
| ECO3030225 | 30 | 225 | 45 | 45 |
| ECO3030250 | 30 | 250 | 45 | 45 |
| ECO3030275 | 30 | 275 | 45 | 45 |
| ECO3030300 | 30 | 300 | 45 | 45 |
| ECO3031115 | 31 | 115 | 45 | 40 |
| ECO3031125 | 31 | 125 | 45 | 40 |
| ECO3031135 | 31 | 135 | 45 | 40 |
| ECO3031145 | 31 | 145 | 45 | 40 |
| ECO3031155 | 31 | 155 | 45 | 40 |
| ECO3031170 | 31 | 170 | 45 | 45 |
| ECO3031185 | 31 | 185 | 45 | 45 |
| ECO3031200 | 31 | 200 | 45 | 45 |
| ECO3031225 | 31 | 225 | 45 | 45 |
| ECO3031250 | 31 | 250 | 45 | 45 |
| ECO3031275 | 31 | 275 | 45 | 45 |
| ECO3031300 | 31 | 300 | 45 | 45 |
| ECO3040145 | 40 | 145 | 55 | 60 |
| ECO3040155 | 40 | 155 | 55 | 60 |
| ECO3040170 | 40 | 170 | 55 | 70 |
| ECO3040185 | 40 | 185 | 55 | 70 |
| ECO3040200 | 40 | 200 | 55 | 70 |
| ECO3040225 | 40 | 225 | 55 | 70 |
| ECO3040250 | 40 | 250 | 55 | 70 |
| ECO3040275 | 40 | 275 | 55 | 70 |
| ECO3040300 | 40 | 300 | 55 | 70 |
| ECO3040325 | 40 | 325 | 55 | 70 |

ECO3

COLONNA CON TESTA



MAT : 1.7131

DUREZZA : 61 ÷ 63 HRC

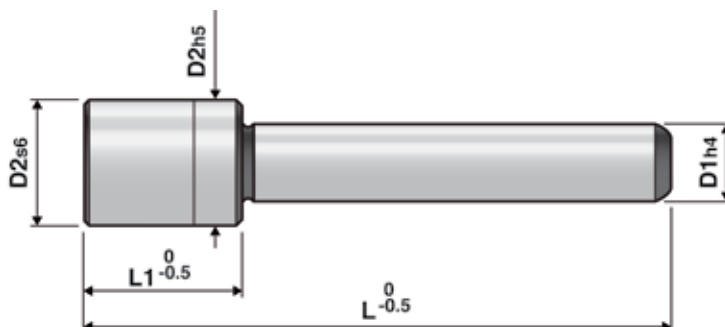

| Codice | D1 | L | D2 | L1 |
|------------|----|-----|----|----|
| ECO3040350 | 40 | 350 | 55 | 70 |
| ECO3040400 | 40 | 400 | 55 | 70 |
| ECO3041145 | 41 | 145 | 55 | 60 |
| ECO3041155 | 41 | 155 | 55 | 60 |
| ECO3041170 | 41 | 170 | 55 | 70 |
| ECO3041185 | 41 | 185 | 55 | 70 |
| ECO3041200 | 41 | 200 | 55 | 70 |
| ECO3041225 | 41 | 225 | 55 | 70 |
| ECO3041250 | 41 | 250 | 55 | 70 |
| ECO3041275 | 41 | 275 | 55 | 70 |
| ECO3041300 | 41 | 300 | 55 | 70 |
| ECO3041325 | 41 | 325 | 55 | 70 |
| ECO3041350 | 41 | 350 | 55 | 70 |
| ECO3041400 | 41 | 400 | 55 | 70 |
| ECO3050170 | 50 | 170 | 70 | 70 |
| ECO3050185 | 50 | 185 | 70 | 70 |
| ECO3050200 | 50 | 200 | 70 | 70 |
| ECO3050225 | 50 | 225 | 70 | 70 |
| ECO3050250 | 50 | 250 | 70 | 70 |
| ECO3050275 | 50 | 275 | 70 | 70 |
| ECO3050300 | 50 | 300 | 70 | 70 |
| ECO3050325 | 50 | 325 | 70 | 70 |
| ECO3050350 | 50 | 350 | 70 | 70 |
| ECO3050400 | 50 | 400 | 70 | 70 |
| ECO3051170 | 51 | 170 | 70 | 70 |
| ECO3051185 | 51 | 185 | 70 | 70 |
| ECO3051200 | 51 | 200 | 70 | 70 |
| ECO3051225 | 51 | 225 | 70 | 70 |
| ECO3051250 | 51 | 250 | 70 | 70 |
| ECO3051275 | 51 | 275 | 70 | 70 |
| ECO3051300 | 51 | 300 | 70 | 70 |
| ECO3051325 | 51 | 325 | 70 | 70 |
| ECO3051350 | 51 | 350 | 70 | 70 |
| ECO3051400 | 51 | 400 | 70 | 70 |