

## EES1HSS

ESPULSORE TESTA CONICA DIN 9861



**MAT** : Acciaio super rapido

**GAMBO** : 62 ÷ 64 HRC

**TESTA** : 52 ± 3 HRC

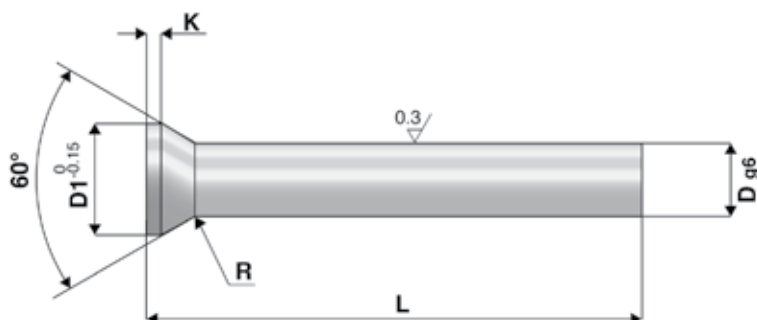

Codice	D	D1	K	L
EES1HSS010125	1.0	1.8	0.5	125
EES1HSS010160	1.0	1.8	0.5	160
EES1HSS01.10125	1.1	1.8	0.5	125
EES1HSS01.10160	1.1	1.8	0.5	160
EES1HSS01.20125	1.2	2.0	0.5	125
EES1HSS01.20160	1.2	2.0	0.5	160
EES1HSS01.30125	1.3	2.0	0.5	125
EES1HSS01.30160	1.3	2.0	0.5	160
EES1HSS01.40125	1.4	2.2	0.5	125
EES1HSS01.40160	1.4	2.2	0.5	160
EES1HSS01.50125	1.5	2.2	0.5	125
EES1HSS01.50160	1.5	2.2	0.5	160
EES1HSS01.60125	1.6	2.5	0.5	125
EES1HSS01.60160	1.6	2.5	0.5	160
EES1HSS01.70125	1.7	2.5	0.5	125
EES1HSS01.70160	1.7	2.5	0.5	160
EES1HSS01.80125	1.8	2.8	0.5	125
EES1HSS01.80160	1.8	2.8	0.5	160
EES1HSS01.90125	1.9	2.8	0.5	125
EES1HSS01.90160	1.9	2.8	0.5	160
EES1HSS020125	2.0	3.0	0.5	125
EES1HSS020160	2.0	3.0	0.5	160
EES1HSS020200	2.0	3.0	0.5	200
EES1HSS020250	2.0	3.0	0.5	250
EES1HSS02.10125	2.1	3.2	0.5	125
EES1HSS02.10160	2.1	3.2	0.5	160
EES1HSS02.10200	2.1	3.2	0.5	200
EES1HSS02.10250	2.1	3.2	0.5	250
EES1HSS02.20125	2.2	3.2	0.5	125
EES1HSS02.20160	2.2	3.2	0.5	160
EES1HSS02.20200	2.2	3.2	0.5	200
EES1HSS02.20250	2.2	3.2	0.5	250
EES1HSS02.30125	2.3	3.5	0.5	125
EES1HSS02.30160	2.3	3.5	0.5	160
EES1HSS02.30200	2.3	3.5	0.5	200
EES1HSS02.30250	2.3	3.5	0.5	250
EES1HSS02.40125	2.4	3.5	0.5	125

Codice	D	D1	K	L
EES1HSS02.40160	2.4	3.5	0.5	160
EES1HSS02.40200	2.4	3.5	0.5	200
EES1HSS02.40250	2.4	3.5	0.5	250
EES1HSS02.50125	2.5	3.5	0.5	125
EES1HSS02.50160	2.5	3.5	0.5	160
EES1HSS02.50200	2.5	3.5	0.5	200
EES1HSS02.50250	2.5	3.5	0.5	250
EES1HSS02.60125	2.6	4.0	0.5	125
EES1HSS02.60160	2.6	4.0	0.5	160
EES1HSS02.60200	2.6	4.0	0.5	200
EES1HSS02.60250	2.6	4.0	0.5	250
EES1HSS02.70125	2.7	4.0	0.5	125
EES1HSS02.70160	2.7	4.0	0.5	160
EES1HSS02.70200	2.7	4.0	0.5	200
EES1HSS02.70250	2.7	4.0	0.5	250
EES1HSS02.80125	2.8	4.0	0.5	125
EES1HSS02.80160	2.8	4.0	0.5	160
EES1HSS02.80200	2.8	4.0	0.5	200
EES1HSS02.80250	2.8	4.0	0.5	250
EES1HSS02.90125	2.9	4.0	0.5	125
EES1HSS02.90160	2.9	4.0	0.5	160
EES1HSS02.90200	2.9	4.0	0.5	200
EES1HSS02.90250	2.9	4.0	0.5	250
EES1HSS030125	3.0	4.5	0.5	125
EES1HSS030160	3.0	4.5	0.5	160
EES1HSS030200	3.0	4.5	0.5	200
EES1HSS030250	3.0	4.5	0.5	250
EES1HSS03.10125	3.1	4.5	0.5	125
EES1HSS03.10160	3.1	4.5	0.5	160
EES1HSS03.10200	3.1	4.5	0.5	200
EES1HSS03.10250	3.1	4.5	0.5	250
EES1HSS03.20125	3.2	4.5	0.5	125
EES1HSS03.20160	3.2	4.5	0.5	160
EES1HSS03.20200	3.2	4.5	0.5	200
EES1HSS03.20250	3.2	4.5	0.5	250
EES1HSS03.50125	3.5	5.0	0.5	125
EES1HSS03.50160	3.5	5.0	0.5	160

## EES1HSS

ESPULSORE TESTA CONICA DIN 9861



**MAT** : Acciaio super rapido

**GAMBO** : 62 ÷ 64 HRC

**TESTA** : 52 ± 3 HRC

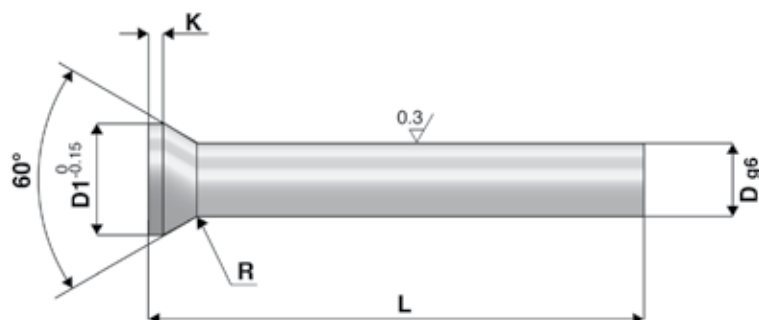

Codice	D	D1	K	L
EES1HSS03.50200	3.5	5.0	0.5	200
EES1HSS03.50250	3.5	5.0	0.5	250
EES1HSS03.60125	3.6	5.0	0.5	125
EES1HSS03.60160	3.6	5.0	0.5	160
EES1HSS03.60200	3.6	5.0	0.5	200
EES1HSS03.60250	3.6	5.0	0.5	250
EES1HSS03.70125	3.7	5.0	0.5	125
EES1HSS03.70160	3.7	5.0	0.5	160
EES1HSS03.70200	3.7	5.0	0.5	200
EES1HSS03.70250	3.7	5.0	0.5	250
EES1HSS040125	4.0	5.5	0.5	125
EES1HSS040160	4.0	5.5	0.5	160
EES1HSS040200	4.0	5.5	0.5	200
EES1HSS040250	4.0	5.5	0.5	250
EES1HSS04.10125	4.1	5.5	0.5	125
EES1HSS04.10160	4.1	5.5	0.5	160
EES1HSS04.10200	4.1	5.5	0.5	200
EES1HSS04.10250	4.1	5.5	0.5	250
EES1HSS04.20125	4.2	5.5	0.5	125
EES1HSS04.20160	4.2	5.5	0.5	160
EES1HSS04.20200	4.2	5.5	0.5	200
EES1HSS04.20250	4.2	5.5	0.5	250
EES1HSS04.50125	4.5	6.0	0.5	125
EES1HSS04.50160	4.5	6.0	0.5	160
EES1HSS04.50200	4.5	6.0	0.5	200
EES1HSS04.50250	4.5	6.0	0.5	250
EES1HSS04.60125	4.6	6.0	0.5	125
EES1HSS04.60160	4.6	6.0	0.5	160
EES1HSS04.60200	4.6	6.0	0.5	200
EES1HSS04.60250	4.6	6.0	0.5	250
EES1HSS04.70125	4.7	6.0	0.5	125
EES1HSS04.70160	4.7	6.0	0.5	160
EES1HSS04.70200	4.7	6.0	0.5	200
EES1HSS04.70250	4.7	6.0	0.5	250
EES1HSS050125	5.0	6.5	0.5	125
EES1HSS050160	5.0	6.5	0.5	160
EES1HSS050200	5.0	6.5	0.5	200

Codice	D	D1	K	L
EES1HSS050250	5.0	6.5	0.5	250
EES1HSS05.10125	5.1	6.5	0.5	125
EES1HSS05.10160	5.1	6.5	0.5	160
EES1HSS05.10200	5.1	6.5	0.5	200
EES1HSS05.10250	5.1	6.5	0.5	250
EES1HSS05.20125	5.2	6.5	0.5	125
EES1HSS05.20160	5.2	6.5	0.5	160
EES1HSS05.20200	5.2	6.5	0.5	200
EES1HSS05.20250	5.2	6.5	0.5	250
EES1HSS05.50125	5.5	7.0	0.5	125
EES1HSS05.50160	5.5	7.0	0.5	160
EES1HSS05.50200	5.5	7.0	0.5	200
EES1HSS05.50250	5.5	7.0	0.5	250
EES1HSS05.60125	5.6	7.0	0.5	125
EES1HSS05.60160	5.6	7.0	0.5	160
EES1HSS05.60200	5.6	7.0	0.5	200
EES1HSS05.60250	5.6	7.0	0.5	250
EES1HSS05.70125	5.7	7.0	0.5	125
EES1HSS05.70160	5.7	7.0	0.5	160
EES1HSS05.70200	5.7	7.0	0.5	200
EES1HSS05.70250	5.7	7.0	0.5	250
EES1HSS060125	6.0	8.0	0.5	125
EES1HSS060160	6.0	8.0	0.5	160
EES1HSS060200	6.0	8.0	0.5	200
EES1HSS060250	6.0	8.0	0.5	250
EES1HSS06.10125	6.1	8.0	0.5	125
EES1HSS06.10160	6.1	8.0	0.5	160
EES1HSS06.10200	6.1	8.0	0.5	200
EES1HSS06.10250	6.1	8.0	0.5	250
EES1HSS06.20125	6.2	8.0	0.5	125
EES1HSS06.20160	6.2	8.0	0.5	160
EES1HSS06.20200	6.2	8.0	0.5	200
EES1HSS06.20250	6.2	8.0	0.5	250
EES1HSS06.50125	6.5	9.0	1.0	125
EES1HSS06.50160	6.5	9.0	1.0	160
EES1HSS06.50200	6.5	9.0	1.0	200
EES1HSS06.50250	6.5	9.0	1.0	250

## EES1HSS

ESPULSORE TESTA CONICA DIN 9861



**MAT** : Acciaio super rapido

**GAMBO** : 62 ÷ 64 HRC

**TESTA** : 52 ± 3 HRC

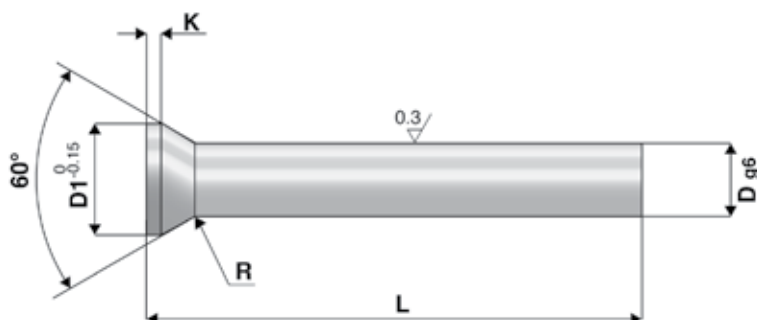

Codice	D	D1	K	L
EES1HSS06.60125	6.6	9.0	1.0	125
EES1HSS06.60160	6.6	9.0	1.0	160
EES1HSS06.60200	6.6	9.0	1.0	200
EES1HSS06.60250	6.6	9.0	1.0	250
EES1HSS06.70125	6.7	9.0	1.0	125
EES1HSS06.70160	6.7	9.0	1.0	160
EES1HSS06.70200	6.7	9.0	1.0	200
EES1HSS06.70250	6.7	9.0	1.0	250
EES1HSS07.0125	7.0	9.0	1.0	125
EES1HSS07.0160	7.0	9.0	1.0	160
EES1HSS07.0200	7.0	9.0	1.0	200
EES1HSS07.0250	7.0	9.0	1.0	250
EES1HSS07.10125	7.1	9.0	1.0	125
EES1HSS07.10160	7.1	9.0	1.0	160
EES1HSS07.10200	7.1	9.0	1.0	200
EES1HSS07.10250	7.1	9.0	1.0	250
EES1HSS07.20125	7.2	9.0	1.0	125
EES1HSS07.20160	7.2	9.0	1.0	160
EES1HSS07.20200	7.2	9.0	1.0	200
EES1HSS07.20250	7.2	9.0	1.0	250
EES1HSS07.50125	7.5	10.0	1.0	125
EES1HSS07.50160	7.5	10.0	1.0	160
EES1HSS07.50200	7.5	10.0	1.0	200
EES1HSS07.50250	7.5	10.0	1.0	250
EES1HSS07.60125	7.6	10.0	1.0	125
EES1HSS07.60160	7.6	10.0	1.0	160
EES1HSS07.60200	7.6	10.0	1.0	200
EES1HSS07.60250	7.6	10.0	1.0	250
EES1HSS08.0125	8.0	10.0	1.0	125
EES1HSS08.0160	8.0	10.0	1.0	160
EES1HSS08.0200	8.0	10.0	1.0	200
EES1HSS08.0250	8.0	10.0	1.0	250
EES1HSS08.10125	8.1	10.0	1.0	125
EES1HSS08.10160	8.1	10.0	1.0	160
EES1HSS08.10200	8.1	10.0	1.0	200
EES1HSS08.10250	8.1	10.0	1.0	250
EES1HSS08.20125	8.2	10.0	1.0	125

Codice	D	D1	K	L
EES1HSS08.20160	8.2	10.0	1.0	160
EES1HSS08.20200	8.2	10.0	1.0	200
EES1HSS08.20250	8.2	10.0	1.0	250
EES1HSS08.50125	8.5	11.0	1.0	125
EES1HSS08.50160	8.5	11.0	1.0	160
EES1HSS08.50200	8.5	11.0	1.0	200
EES1HSS08.50250	8.5	11.0	1.0	250
EES1HSS08.60125	8.6	11.0	1.0	125
EES1HSS08.60160	8.6	11.0	1.0	160
EES1HSS08.60200	8.6	11.0	1.0	200
EES1HSS08.60250	8.6	11.0	1.0	250
EES1HSS09.0125	9.0	11.0	1.0	125
EES1HSS09.0160	9.0	11.0	1.0	160
EES1HSS09.0200	9.0	11.0	1.0	200
EES1HSS09.0250	9.0	11.0	1.0	250
EES1HSS09.50125	9.5	12.0	1.0	125
EES1HSS09.50160	9.5	12.0	1.0	160
EES1HSS09.50200	9.5	12.0	1.0	200
EES1HSS09.50250	9.5	12.0	1.0	250
EES1HSS10.0125	10.0	12.0	1.0	125
EES1HSS10.0160	10.0	12.0	1.0	160
EES1HSS10.0200	10.0	12.0	1.0	200
EES1HSS10.0250	10.0	12.0	1.0	250
EES1HSS10.50125	10.5	13.0	1.0	125
EES1HSS10.50160	10.5	13.0	1.0	160
EES1HSS10.50200	10.5	13.0	1.0	200
EES1HSS10.50250	10.5	13.0	1.0	250
EES1HSS11.0125	11.0	13.0	1.0	125
EES1HSS11.0160	11.0	13.0	1.0	160
EES1HSS11.0200	11.0	13.0	1.0	200
EES1HSS11.0250	11.0	13.0	1.0	250
EES1HSS11.50125	11.5	14.0	1.0	125
EES1HSS11.50160	11.5	14.0	1.0	160
EES1HSS11.50200	11.5	14.0	1.0	200
EES1HSS11.50250	11.5	14.0	1.0	250
EES1HSS12.0125	12.0	14.0	1.0	125
EES1HSS12.0160	12.0	14.0	1.0	160

## EES1HSS

ESPULSORE TESTA CONICA DIN 9861



**MAT** : Acciaio super rapido

**GAMBO** : 62 ÷ 64 HRC

**TESTA** : 52 ± 3 HRC

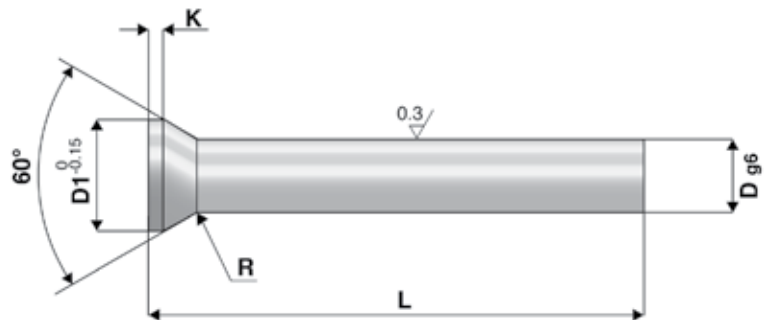

Codice	D	D1	K	L
EES1HSS120200	12.0	14.0	1.0	200
EES1HSS120250	12.0	14.0	1.0	250
EES1HSS12.50125	12.5	15.0	1.0	125
EES1HSS12.50160	12.5	15.0	1.0	160
EES1HSS12.50200	12.5	15.0	1.0	200
EES1HSS12.50250	12.5	15.0	1.0	250
EES1HSS130125	13.0	15.0	1.0	125
EES1HSS130160	13.0	15.0	1.0	160
EES1HSS130200	13.0	15.0	1.0	200
EES1HSS130250	13.0	15.0	1.0	250
EES1HSS13.50125	13.5	16.0	1.5	125
EES1HSS13.50160	13.5	16.0	1.5	160
EES1HSS13.50200	13.5	16.0	1.5	200
EES1HSS13.50250	13.5	16.0	1.5	250
EES1HSS140125	14.0	16.0	1.5	125
EES1HSS140160	14.0	16.0	1.5	160
EES1HSS140200	14.0	16.0	1.5	200
EES1HSS140250	14.0	16.0	1.5	250
EES1HSS14.50125	14.5	17.0	1.5	125
EES1HSS14.50160	14.5	17.0	1.5	160
EES1HSS14.50200	14.5	17.0	1.5	200
EES1HSS14.50250	14.5	17.0	1.5	250
EES1HSS150125	15.0	17.0	1.5	125
EES1HSS150160	15.0	17.0	1.5	160
EES1HSS150200	15.0	17.0	1.5	200
EES1HSS150250	15.0	17.0	1.5	250
EES1HSS15.50125	15.5	18.0	1.5	125
EES1HSS15.50160	15.5	18.0	1.5	160
EES1HSS15.50200	15.5	18.0	1.5	200

Codice	D	D1	K	L
EES1HSS15.50250	15.5	18.0	1.5	250
EES1HSS160125	16.0	18.0	1.5	125
EES1HSS160160	16.0	18.0	1.5	160
EES1HSS160200	16.0	18.0	1.5	200
EES1HSS160250	16.0	18.0	1.5	250
EES1HSS16.50125	16.5	19.0	1.5	125
EES1HSS16.50160	16.5	19.0	1.5	160
EES1HSS16.50200	16.5	19.0	1.5	200
EES1HSS16.50250	16.5	19.0	1.5	250
EES1HSS170125	17.0	19.0	1.5	125
EES1HSS170160	17.0	19.0	1.5	160
EES1HSS170200	17.0	19.0	1.5	200
EES1HSS170250	17.0	19.0	1.5	250
EES1HSS17.50125	17.5	20.0	1.5	125
EES1HSS17.50160	17.5	20.0	1.5	160
EES1HSS17.50200	17.5	20.0	1.5	200
EES1HSS17.50250	17.5	20.0	1.5	250
EES1HSS180125	18.0	20.0	1.5	125
EES1HSS180160	18.0	20.0	1.5	160
EES1HSS180200	18.0	20.0	1.5	200
EES1HSS180250	18.0	20.0	1.5	250
EES1HSS18.50125	18.5	21.0	1.5	125
EES1HSS18.50160	18.5	21.0	1.5	160
EES1HSS18.50200	18.5	21.0	1.5	200
EES1HSS18.50250	18.5	21.0	1.5	250
EES1HSS200125	20.0	22.0	1.5	125
EES1HSS200160	20.0	22.0	1.5	160
EES1HSS200200	20.0	22.0	1.5	200
EES1HSS200250	20.0	22.0	1.5	250