

## TCN/F

ESPULSORE TESTA CILINDRICA  
NITRURATO TIPO FIAT

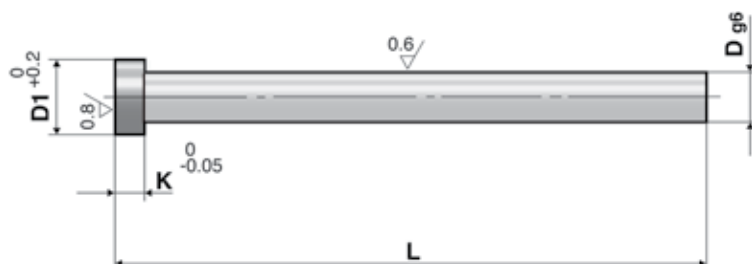

MAT : DIN 1.2344  
TESTA : 45 ± 5 HRC  
CORPO : 950 Vikers



Codice	D	L	D1	K
TCN/F03.50100	3.5	100	7	3
TCN/F03.50125	3.5	125	7	3
TCN/F03.50160	3.5	160	7	3
TCN/F03.50200	3.5	200	7	3
TCN/F03.50250	3.5	250	7	3
TCN/F03.50315	3.5	315	7	3
TCN/F03.50400	3.5	400	7	3
TCN/F03.50500	3.5	500	7	3
TCN/F03.50630	3.5	630	7	3
TCN/F040100	4.0	100	8	4
TCN/F040125	4.0	125	8	4
TCN/F040160	4.0	160	8	4
TCN/F040200	4.0	200	8	4
TCN/F040250	4.0	250	8	4
TCN/F040315	4.0	315	8	4
TCN/F040400	4.0	400	8	4
TCN/F040500	4.0	500	8	4
TCN/F040630	4.0	630	8	4
TCN/F040800	4.0	800	8	4
TCN/F041000	4.0	1000	8	4
TCN/F04.20100	4.2	100	8	4
TCN/F04.20125	4.2	125	8	4
TCN/F04.20160	4.2	160	8	4
TCN/F04.20200	4.2	200	8	4
TCN/F04.20250	4.2	250	8	4
TCN/F04.20315	4.2	315	8	4
TCN/F04.20400	4.2	400	8	4
TCN/F04.20500	4.2	500	8	4
TCN/F04.20630	4.2	630	8	4
TCN/F04.20800	4.2	800	8	4
TCN/F04.21000	4.2	1000	8	4
TCN/F04.50100	4.5	100	8	4
TCN/F04.50125	4.5	125	8	4
TCN/F04.50160	4.5	160	8	4
TCN/F04.50200	4.5	200	8	4
TCN/F04.50250	4.5	250	8	4
TCN/F04.50315	4.5	315	8	4

Codice	D	L	D1	K
TCN/F04.50400	4.5	400	8	4
TCN/F050100	5.0	100	10	5
TCN/F050125	5.0	125	10	5
TCN/F050160	5.0	160	10	5
TCN/F050200	5.0	200	10	5
TCN/F050250	5.0	250	10	5
TCN/F050315	5.0	315	10	5
TCN/F050400	5.0	400	10	5
TCN/F050500	5.0	500	10	5
TCN/F050630	5.0	630	10	5
TCN/F050800	5.0	800	10	5
TCN/F051000	5.0	1000	10	5
TCN/F05.20100	5.2	100	10	5
TCN/F05.20125	5.2	125	10	5
TCN/F05.20160	5.2	160	10	5
TCN/F05.20200	5.2	200	10	5
TCN/F05.20250	5.2	250	10	5
TCN/F05.20315	5.2	315	10	5
TCN/F05.20400	5.2	400	10	5
TCN/F05.20500	5.2	500	10	5
TCN/F05.20630	5.2	630	10	5
TCN/F05.20800	5.2	800	10	5
TCN/F05.21000	5.2	1000	10	5
TCN/F05.50100	5.5	100	10	5
TCN/F05.50125	5.5	125	10	5
TCN/F05.50160	5.5	160	10	5
TCN/F05.50200	5.5	200	10	5
TCN/F05.50250	5.5	250	10	5
TCN/F05.50315	5.5	315	10	5
TCN/F05.50400	5.5	400	10	5
TCN/F05.50500	5.5	500	10	5
TCN/F05.50630	5.5	630	10	5
TCN/F080100	8.0	100	14	6.5
TCN/F080125	8.0	125	14	6.5
TCN/F080160	8.0	160	14	6.5
TCN/F080200	8.0	200	14	6.5
TCN/F080250	8.0	250	14	6.5

## TCN/F

ESPULSORE TESTA CILINDRICA  
NITRURATO TIPO FIAT



**MAT** : DIN 1.2344  
**TESTA** : 45 ± 5 HRC  
**CORPO** : 950 Vikers

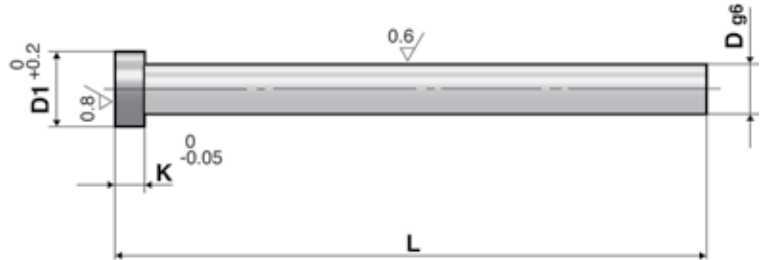

Codice	D	L	D1	K
TCN/F080315	8.0	315	14	6.5
TCN/F080400	8.0	400	14	6.5
TCN/F080500	8.0	500	14	6.5
TCN/F080630	8.0	630	14	6.5
TCN/F080800	8.0	800	14	6.5
TCN/F081000	8.0	1000	14	6.5
TCN/F08.20100	8.2	100	14	6.5
TCN/F08.20125	8.2	125	14	6.5
TCN/F08.20160	8.2	160	14	6.5
TCN/F08.20200	8.2	200	14	6.5
TCN/F08.20250	8.2	250	14	6.5
TCN/F08.20315	8.2	315	14	6.5
TCN/F08.20400	8.2	400	14	6.5
TCN/F08.20500	8.2	500	14	6.5
TCN/F08.20630	8.2	630	14	6.5
TCN/F08.20800	8.2	800	14	6.5
TCN/F08.21000	8.2	1000	14	6.5
TCN/F08.21250	8.2	1250	14	6.5
TCN/F08.50100	8.5	100	14	6.5
TCN/F08.50125	8.5	125	14	6.5
TCN/F08.50160	8.5	160	14	6.5
TCN/F08.50200	8.5	200	14	6.5
TCN/F08.50250	8.5	250	14	6.5
TCN/F08.50315	8.5	315	14	6.5
TCN/F08.50400	8.5	400	14	6.5
TCN/F08.50500	8.5	500	14	6.5
TCN/F08.50630	8.5	630	14	6.5
TCN/F090100	9.0	100	14	6.5
TCN/F090125	9.0	125	14	6.5
TCN/F090160	9.0	160	14	6.5
TCN/F090200	9.0	200	14	6.5
TCN/F090250	9.0	250	14	6.5
TCN/F090315	9.0	315	14	6.5
TCN/F090400	9.0	400	14	6.5
TCN/F090500	9.0	500	14	6.5
TCN/F090630	9.0	630	14	6.5
TCN/F090800	9.0	800	14	6.5

Codice	D	L	D1	K
TCN/F091000	9.0	1000	14	6.5
TCN/F100100	10.0	100	16	6.5
TCN/F100125	10.0	125	16	6.5
TCN/F100160	10.0	160	16	6.5
TCN/F100200	10.0	200	16	6.5
TCN/F100250	10.0	250	16	6.5
TCN/F100315	10.0	315	16	6.5
TCN/F100400	10.0	400	16	6.5
TCN/F100500	10.0	500	16	6.5
TCN/F100630	10.0	630	16	6.5
TCN/F100800	10.0	800	16	6.5
TCN/F101000	10.0	1000	16	6.5
TCN/F101250	10.0	1250	16	6.5
TCN/F10.20100	10.2	100	16	6.5
TCN/F10.20125	10.2	125	16	6.5
TCN/F10.20160	10.2	160	16	6.5
TCN/F10.20200	10.2	200	14	6.5
TCN/F10.20250	10.2	250	14	6.5
TCN/F10.20315	10.2	315	14	6.5
TCN/F10.20400	10.2	400	14	6.5
TCN/F10.50100	10.5	100	16	6.5
TCN/F10.50125	10.5	125	16	6.5
TCN/F10.50160	10.5	160	16	6.5
TCN/F10.50200	10.5	200	16	6.5
TCN/F10.50250	10.5	250	16	6.5
TCN/F10.50315	10.5	315	16	6.5
TCN/F10.50400	10.5	400	16	6.5
TCN/F10.50500	10.5	500	16	6.5
TCN/F10.50630	10.5	630	16	6.5
TCN/F110100	11.0	100	18	6.5
TCN/F110125	11.0	125	18	6.5
TCN/F110160	11.0	160	18	6.5
TCN/F110200	11.0	200	18	6.5
TCN/F110250	11.0	250	18	6.5
TCN/F110315	11.0	315	18	6.5
TCN/F110400	11.0	400	18	6.5
TCN/F110500	11.0	500	18	6.5

## TCN/F

ESPULSORE TESTA CILINDRICA  
NITRURATO TIPO FIAT



MAT : DIN 1.2344  
TESTA : 45 ± 5 HRC  
CORPO : 950 Vickers

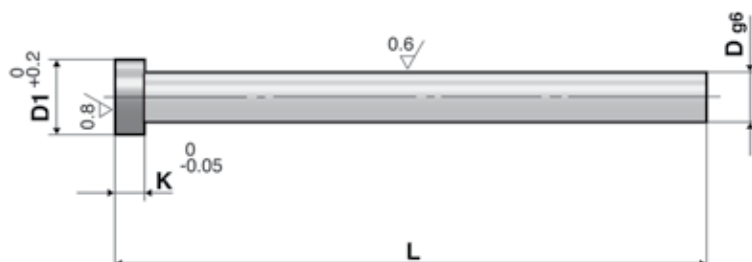

Codice	D	L	D1	K
TCN/F110630	11.0	630	18	6.5
TCN/F110800	11.0	800	18	6.5
TCN/F111000	11.0	1000	18	6.5
TCN/F120100	12.0	100	18	6.5
TCN/F120125	12.0	125	18	6.5
TCN/F120160	12.0	160	18	6.5
TCN/F120200	12.0	200	18	6.5
TCN/F120250	12.0	250	18	6.5
TCN/F120315	12.0	315	18	6.5
TCN/F120400	12.0	400	18	6.5
TCN/F120500	12.0	500	18	6.5
TCN/F120630	12.0	630	18	6.5
TCN/F120800	12.0	800	18	6.5
TCN/F121000	12.0	1000	18	6.5
TCN/F121250	12.0	1250	18	6.5
TCN/F160100	16.0	100	24	7
TCN/F160125	16.0	125	24	7
TCN/F160160	16.0	160	24	7
TCN/F160200	16.0	200	24	7
TCN/F160250	16.0	250	24	7
TCN/F160315	16.0	315	24	7
TCN/F160400	16.0	400	24	7
TCN/F160500	16.0	500	24	7
TCN/F160630	16.0	630	24	7
TCN/F160800	16.0	800	24	7

Codice	D	L	D1	K
TCN/F161000	16.0	1000	24	7
TCN/F161250	16.0	1250	24	7
TCN/F180100	18.0	100	26	7
TCN/F180125	18.0	125	26	7
TCN/F180160	18.0	160	26	7
TCN/F180200	18.0	200	26	7
TCN/F180250	18.0	250	26	7
TCN/F180315	18.0	315	26	7
TCN/F180400	18.0	400	26	7
TCN/F180500	18.0	500	26	7
TCN/F180630	18.0	630	26	7
TCN/F180800	18.0	800	26	7
TCN/F181000	18.0	1000	26	7
TCN/F200100	20.0	100	28	7
TCN/F200125	20.0	125	28	7
TCN/F200160	20.0	160	28	7
TCN/F200200	20.0	200	28	7
TCN/F200250	20.0	250	28	7
TCN/F200315	20.0	315	28	7
TCN/F200400	20.0	400	28	7
TCN/F200500	20.0	500	28	7
TCN/F200630	20.0	630	28	7
TCN/F200800	20.0	800	28	7
TCN/F201000	20.0	1000	28	7
TCN/F201250	20.0	1250	28	7

Su tutti gli estrattori è possibile realizzare rivestimento superficiale **DLC**, **TiCN** e **TiN**.

Specificare in fase di ordine.